

Introduction

The T-bar Handle improves riding comfort and control by reducing pressure at the front of the saddle. Elegantly simple, lightweight and strong, it allows both angle and length adjustment. This lets you set your T-bar to the ideal position for your riding style.

What's Included

The T-Bar handle requires assembly. You will find the following parts included:

- ✓ Reinforcement plate
- ✓ Angles (2)
- ✓ Threaded inserts & M6x10 bolts with washers for the angles (2)
- ✓ Slotted tube
- ✓ T-bar (curved & straight versions)
- ✓ Bar ends (*not shown*)
- ✓ Six M5 x 25 mm bolts for attachment to the saddle.
- ✓ "Seatpost" clamp for the slotted tube (*not shown*)

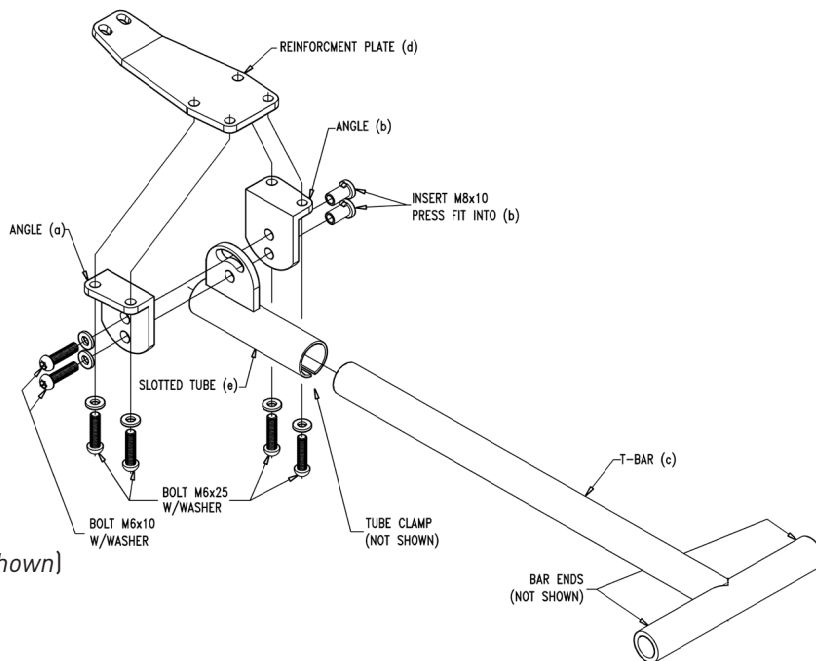

Assembling and Installing Your T-Bar Handle

ALL KH saddle models:

1. Remove the front saddle handle bolts. Remove the plastic handle if replacing it with the T-handle. Otherwise do not remove the plastic handle.
2. Remove the front two seatpost plate bolts (curved saddles only). Do not remove the seatpost.
3. Place the reinforcement plate on the saddle. It may take some pressure to push it in place.
4. Place both angles on top of the plate so that they form a parallel slot.
5. Screw *all* bolts very loosely into the saddle frame. Then tighten all bolts to firm hand pressure.
6. Install the slotted tube between the angles. For more extended T-handle positions, face the seatpost clamp forwards. For shorter T-handle extensions, face the tube clamp towards the rear.
7. Slide the brake lever onto the T-handle. Then slide the T-bar into the slotted tube and tighten with the tube clamp.
8. Once everything is assembled, adjust the angle and length. See the adjustment tips on the next page.

Special Instructions

Fusion One Saddle Model

1. Follow the same assembly instructions as above except: the rear of the reinforcement plate is fixed to the saddle with a single bolt located in front of the Pivotal seatpost.

Fusion Zero Saddle Model (Discontinued)

1. Set aside the reinforcement plate. It is not compatible with this saddle.
2. If the front saddle handle is removed, place 4 thick plastic washers (included) under the angles.
3. Follow the same assembly instructions as above.

Tips and Suggestions

Which to Choose: Curved or Straight Handle?

The T-bar kit includes both a straight handle and a longer handle that curves upwards towards the front. The optimal handle will depend on personal choice and your riding style; however here are some suggestions:

- The straight handle works best when installing the T-bar close to the front of the saddle, especially if used as a replacement for the plastic handle. We recommend this setup for muni as a shorter handle provides greater control.
- The curved handle works best as a longer handle extension. At higher handle angles the bent shape provides more finger clearance below the plastic front handle. We recommend this setup for less technical riding where a more extended, "bike-like" body position is preferred.

Handle Positioning

The optimal handle position depends on personal preference and the type of riding you do. On your first rides, bring a hex key and experiment with different positions until you find what works best. Here are a few tips:

- Riding and braking with the T-bar in an extended position can feel unstable at first. If this is the case, try installing it close to the saddle and gradually move it further forward as you get used to it.
- Many road riders find that extending the handle further forwards provides the most comfort and aerodynamic efficiency. However, for muni or for bumpier roads, try keeping it closer to the saddle. This gives you increased control and lets you pull up harder on the handle while keeping hold of the brake. To move the T-bar as close as possible to the saddle, flip the slotted tube so the "seatpost" clamp faces to the rear, and cut the T-bar shorter as necessary.
- If you have trouble reaching your brake lever between the bar ends or the bar ends are bumping your knees, try cutting the "T" to a narrower width. The minimum recommended "T" width is 110 mm.
- Check the tightness of all bolts after the first ride and after every few rides.
- See the Fusion Zero or Fusion One Comfort Guide for T-bar handle tips when using the handle with one of these saddles under the Resources section at the bottom of <http://www.krisholm.com/en/gear/saddle/fusion-zero> or <http://www.krisholm.com/en/gear/saddle/fusion-one>.



The T-Bar handle is strong but can be damaged in a fall.

Inspect closely after sudden impacts and replace if damaged or broken.

Any and all modifications made by the user are NOT covered by the Kris Holm Unicycles Warranty.



Warranty

Kris Holm Unicycles products are warranted to the original owner against manufacturing defects for one (1) year following the original purchase date. For more details visit <http://www.krisholm.com/legal/warranty>



Unicycling can be hazardous and can result in injuries. Use common sense, ride within your abilities, and wear safety gear. Kris Holm Unicycles cannot accept responsibility for any personal injury that you might sustain or that you might cause to another person as a result of the use, breakage or improper assembly of Kris Holm Unicycles equipment.